

LOC		DIST		REVISIONS			
P	LTR	DATE	DN	APVD			
S1		REVISD PER ECO-08-002028	23JAN08	DH	AS		

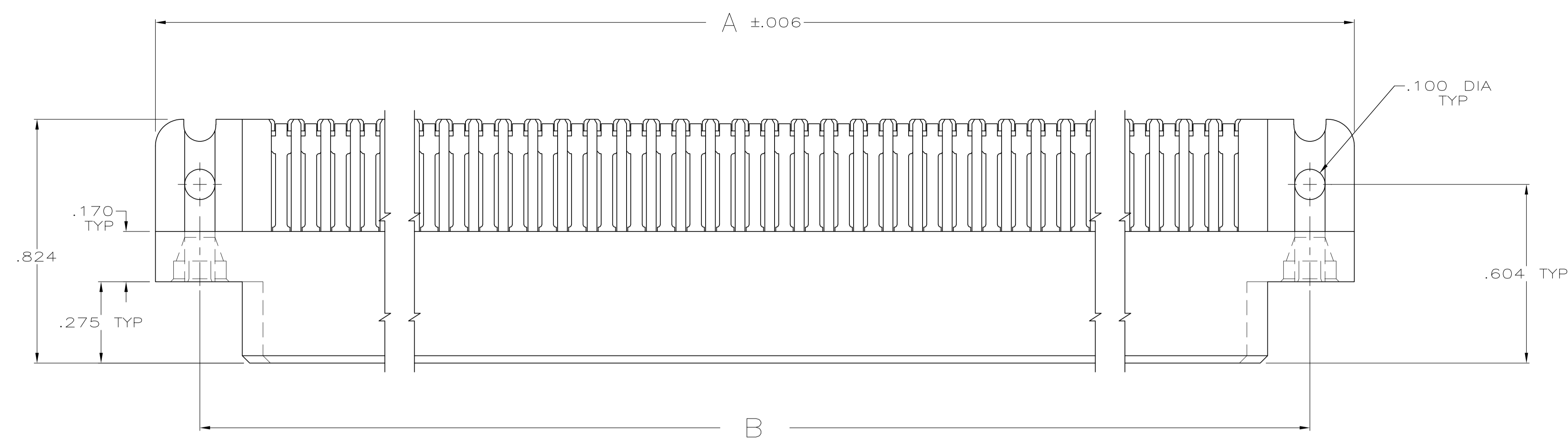

- △ HOUSING MATERIAL: THERMOPLASTIC.
- △ CONTACT MATERIAL: COPPER ALLOY.
- △ CONTACT FINISH: .000050-.000100 NICKEL UNDERPLATE ALL OVER WITH .000030 GOLD IN CONTACT AREA AND .000100-.000200 TIN-LEAD PLATED POSTS
- △ MAX BOW ALLOWANCE IS .0165 INCH.

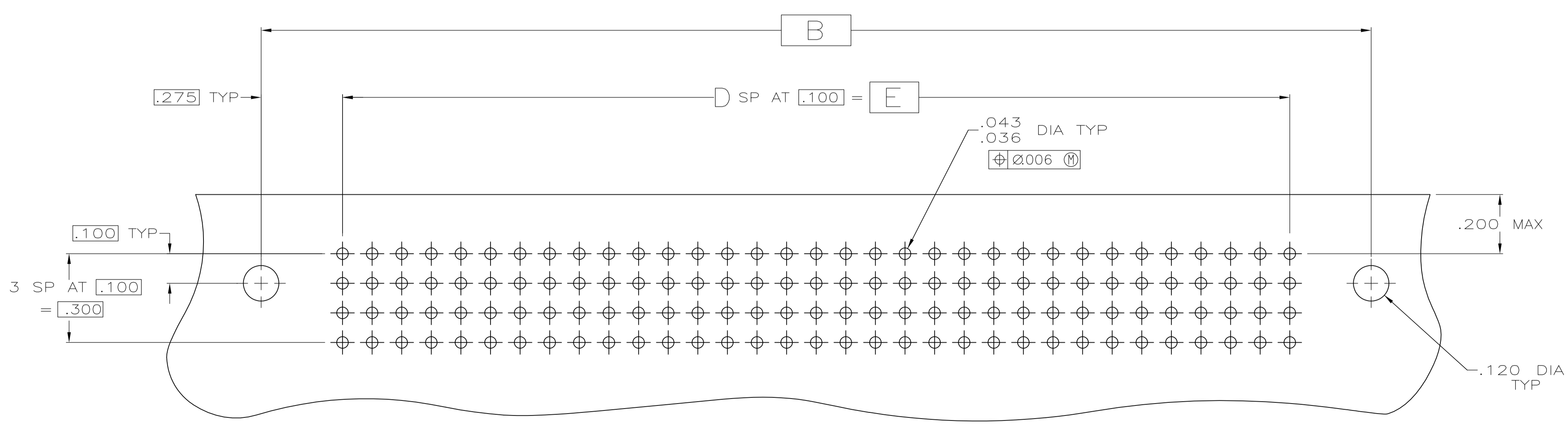
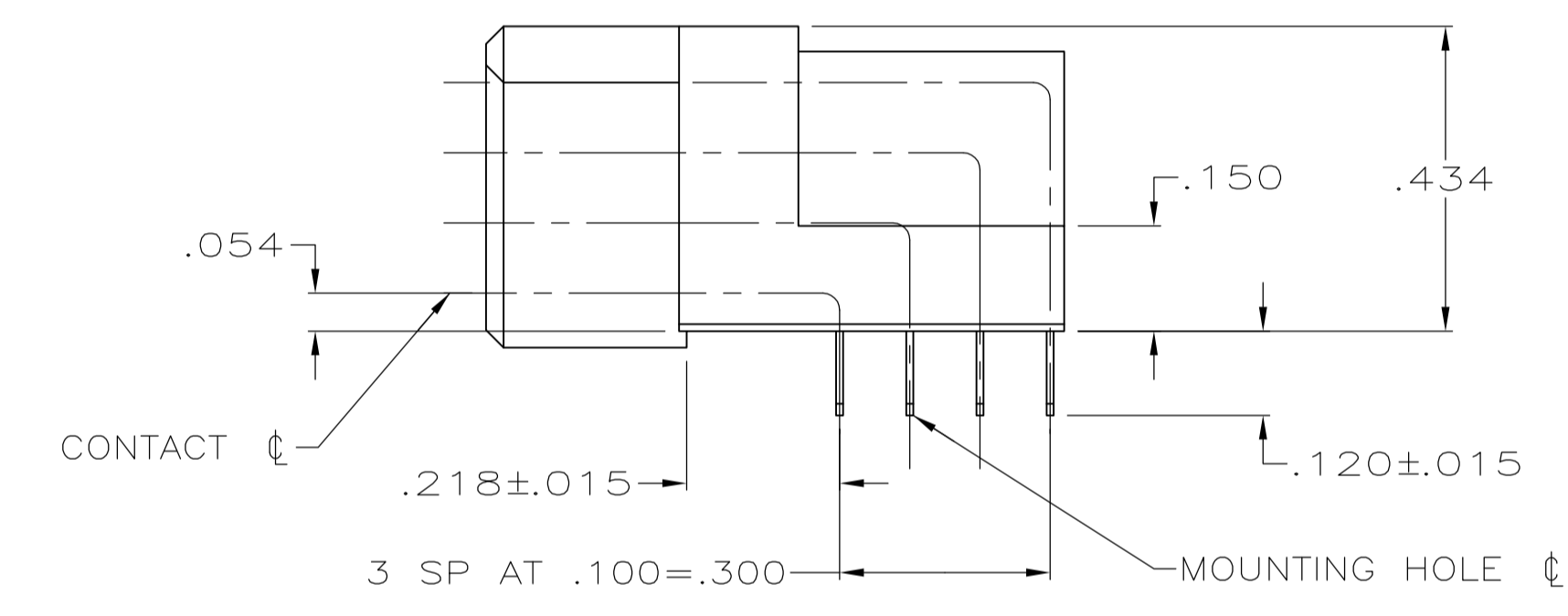
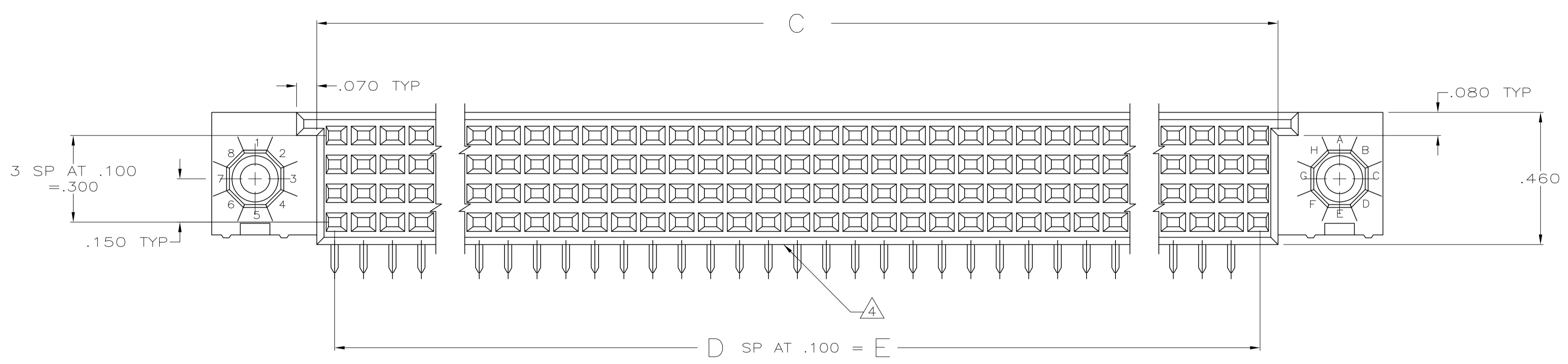

OBSOLETE	.800	8	.924	1.350	1.650	36	2-534008-1
OBSOLETE	.500	5	.624	1.050	1.350	24	2-534008-0
OBSOLETE	6.900	69	7.024	7.450	7.750	280	1-534008-8
OBSOLETE	4.100	41	4.224	4.650	4.950	168	1-534008-7
OBSOLETE	5.400	54	5.524	5.950	6.250	220	1-534008-6
OBSOLETE	7.000	70	7.124	7.550	7.850	284	1-534008-5
OBSOLETE	6.400	64	6.524	6.950	7.250	260	1-534008-4
OBSOLETE	5.900	59	6.024	6.450	6.750	240	1-534008-3
△ OBSOLETE	7.400	74	7.524	7.950	8.250	300	1-534008-2
	4.900	49	5.024	5.450	5.750	200	1-534008-1
	3.900	39	4.024	4.450	4.750	160	1-534008-0
	3.400	34	3.524	3.950	4.250	140	534008-9
	3.100	31	3.224	3.650	3.950	128	534008-8
	2.900	29	3.024	3.450	3.750	120	534008-7
OBSOLETE	1.900	19	2.024	2.450	2.750	80	534008-6
OBSOLETE	1.400	14	1.524	1.950	2.250	60	534008-5
OBSOLETE	1.100	11	1.224	1.650	1.950	48	534008-4
OBSOLETE	.900	9	1.024	1.450	1.750	40	534008-3
OBSOLETE	.700	7	.824	1.250	1.550	32	534008-2
	2.400	24	2.524	2.950	3.250	100	534008-1
	E	D	C	B	A	NO OF POSN	PART NUMBER

RECOMMENDED P.C. BOARD LAYOUT

THIS DRAWING IS A CONTROLLED DOCUMENT. 5-23-91
 J. GALLUCCI, BG 12/10/91
 DAVID HOFFMAN 12/10/91
 Tyco Electronics Corporation
 Harrisburg, PA 17105-3608

DIMENSIONS: INCHES	TOLERANCES UNLESS OTHERWISE SPECIFIED:	0. PLC ± -	1. PLC ± -	2. PLC ± -	3. PLC ± .005	4. PLC ± -	ANGLES ± -
MATERIAL		FINISH		SIZE	CAGE CODE	DRAWING NO	RESTRICTED TO
				A1	00779	534008	

ASSEMBLY, RECEPTACLE, TWIN BEAM CONNECTOR, 4 ROW, 2 MOUNTING HOLES, .120 POST LENGTH
 114-9008
 WEIGHT -
 SCALE 4:1 SHEET 1 OF 1 REV S1
 CUSTOMER DRAWING